

A PRINT OUT FROM A CAD PROGRAM TO ENABLE A 54 HOLE DIVISION PLATE TO BE MADE BY CENTRE PUNCHING THROUGH THE PRINT OUT ONTO THE EVENTUAL DIVISION PLATE WHICH WILL THEN BE DRILLED WITH THE REQUIRED HOLES.

CAD PLOTTED DIVISION PLATE SK.3

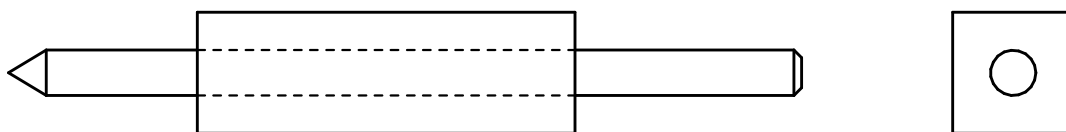

THE GUIDE MADE FROM MILD STEEL DRILLED AND REAMED TO BE A CLOSE FIT ON THE SILVER STEEL CENTRE PUNCH

CENTRE PUNCH MADE FROM SILVER STEEL AND HARDENED JUST AT THE POINTED END

GUIDED CENTRE PUNCH SK.4