

A. ROTARY TABLE AND UPPER PLATE LOCATER B. UPPER PLATE
 C. WORKPIECE LOCATER D. ANTI TURN PIN AND NOTCH

WORKPIECE POSITIONING JIG

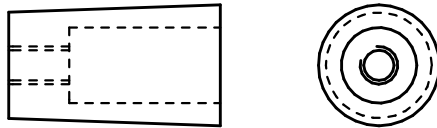

NOTES

1. IF YOUR ROTARY TABLE HAS A TAPERED BORE YOU WILL NEED TO MAKE AN ADAPTOR. IT DOES NOT NEED TO BE THE FULL LENGTH TAPER, 40MM WOULD BE SUFFICIENT.
2. THE TAPER AND BORE MUST BE CONCENTRIC.
3. THE THREAD IS FOR JACKING OUT THE ADAPTOR FROM THE ROTARY TABLE BORE.

TAPER TO PARALLEL ADAPTOR